

KEY TO WIRING CODES FOR FIGURE 6

(Circuit Descriptions—Tractors with "A" or "B" Prefixed Serial Numbers)

Wire No.	Wire Description	Wire Code
1	Regulator "D" to generator "D"	Brown-Yellow
2	Regulator "F" to generator "F"	Brown-Green
3	Regulator "B" to starting motor solenoid	Brown
4	Regulator "B" to key-starter switch	Brown
5	Regulator "E" to ground	Black
6	Regulator "WL" to generator warning light	Brown-Yellow
7	Starting motor solenoid to safety-starter switch	White-Red
8	Key-starter switch to safety-starter switch	White-Yellow
9	Key-starter switch to thermostart(diesel) (to coil—gasoline)	Brown-Red
10	Key-starter switch to instrument panel voltage stabilizer	White
11	Key-starter switch feed to fuse	Brown
12	Key-starter switch to accessories	White
13	Light switch to side and rear lamps	Red
14	Light switch to headlamp low beam	Blue-Red
15	Light switch to headlamp main beam	Blue-White
16	Light switch to panel light connection	Red-White
17	Oil pressure switch to oil pressure warning light connection	White-Brown
18	Horn to horn button	White-Green
19	Instrument panel ground to regulator "E"	Black
20	Fuel tank unit to instrument panel ground	Black
21	Fuel tank unit to fuel gauge connection	Green-Black
22	Horn to regulator "E"	Black
23	Instrument panel feed to warning light connection	White
24	Instrument panel warning light connection to generator warning light	White
25	Instrument panel warning light connection to oil pressure warning light	White
26	Temperature sender unit to temperature gauge	Green-Blue
27	Voltage stabilizer to fuel gauge	Green-Blue
28	Fuse to light switch	Brown

3. INSTRUMENT CLUSTER

The instrument cluster, Figure 8, includes the Proof-Meter, fuel gauge, temperature gauge, generator indicator light, engine oil pressure light, and a constant voltage stabilizer. The voltage stabilizer maintains approximately 10 volts for fuel and temperature gauge operation.

In order to service any of the components, the cluster must be removed. The warning light bulbs are serviced after performing step 2 under "A. Removal".

A. Removal

NOTE: The instrument cluster assembly contains delicate instruments and gauges. Use extreme care during maintenance and repair, not to drop, jar, or cause other damage to the assembly.

1. Disconnect the ground (negative) cable from the battery.
2. Remove the four screws securing the cluster

assembly, Figure 8, to the rear hood panel assembly.

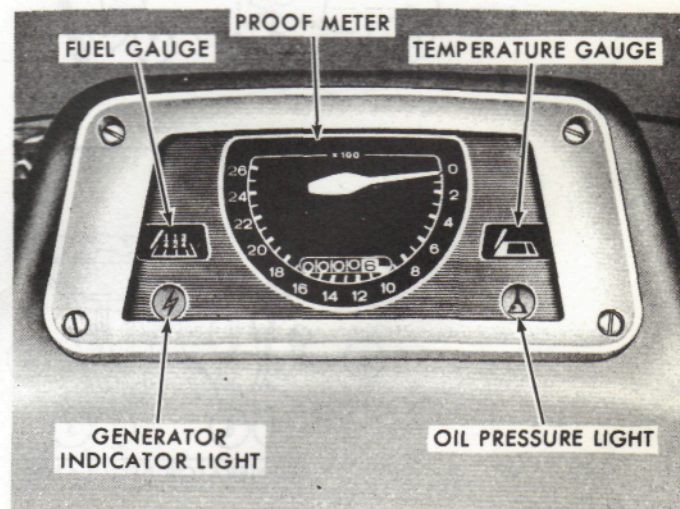

Figure 8
Instrument Cluster Assembly

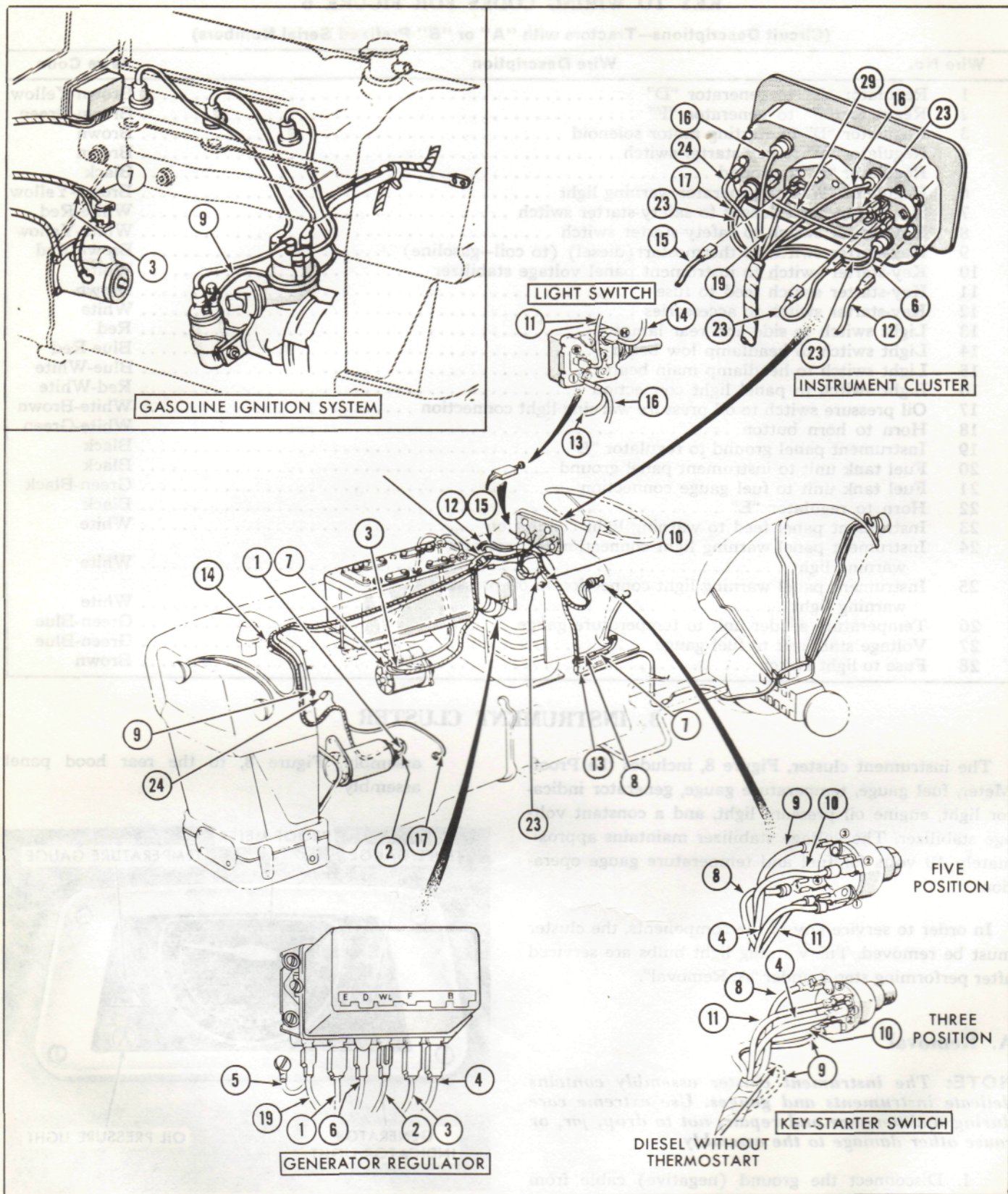

Figure 7
Circuit Descriptions—Tractors with "C" Prefixed Serial Numbers